

1 Unpack

1x



4x



2x



2 Prepare

The Easy-Grow Auto Vent Opener can be attached to most windows. If you have window fixtures installed, prepare your window by removing any existing handles and fixtures from the window and frame. Make sure the window opens easily.

3 Assemble

Slide piston rod and cylinder through set collar of arm A.

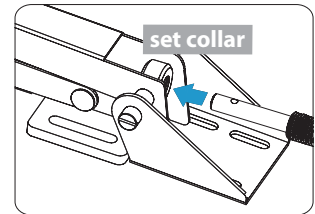
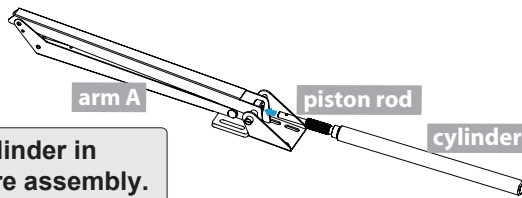

NOTE: For easier assembly, put the cylinder in the refrigerator for a few minutes before assembly.

to windows opening at least 40cm (17 3/4")

Slide piston rod and cylinder through set collar of arm A. Continue sliding cylinder so piston rod fits into push arm and arm begins to open. Align hole in piston rod with second hole in push arm and insert push pin to secure.

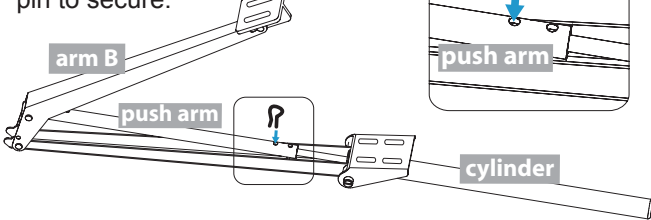

OR to windows opening between 30cm to 40cm (11 3/4" to 17 3/4")

Slide piston rod and cylinder through set collar of arm A. Continue sliding cylinder so piston rod fits into push arm and arm B begins to open. Align hole in piston rod with first hole in push arm. Insert push pin to secure. Then insert stop pin through hole in back of arm B.

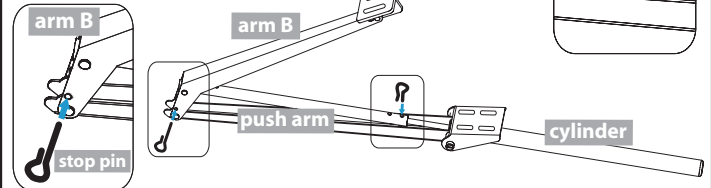

Slide cylinder so threaded area enters set collar. Turn cylinder clockwise to screw cylinder into set collar. As you continue turning, the piston rod forces the push arm back, pushing arm A and arm B together.

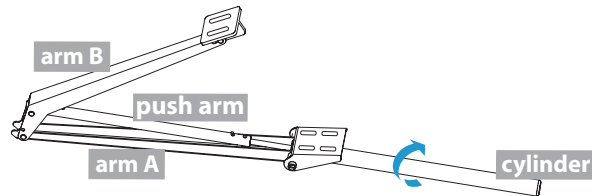

4 Install to most greenhouses

From the inside of the greenhouse open arms of auto vent slightly. Place window bracket on arm B onto window frame and secure with two 3/8" self tapping screws (screw A).

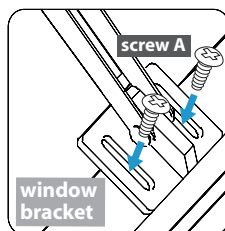
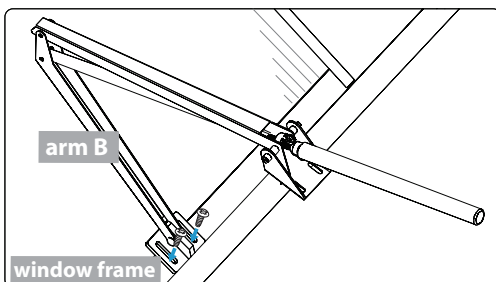

Place frame bracket on arm A onto window sill just below frame bracket and secure with two 1" self tapping screws (screw B). Note: If your sill is thinner use the extra set of screw A provided in the package.

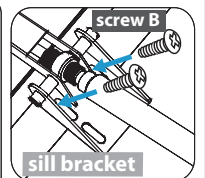
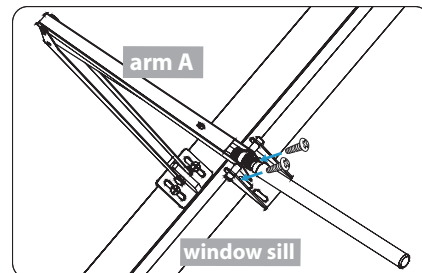

Carefully push upper handle B down until window closes completely. Turn cylinder clockwise until threaded area of cylinder is centered to set collar as shown.

IMPORTANT: Tighten the cylinder when you finish or the auto vent will not function.

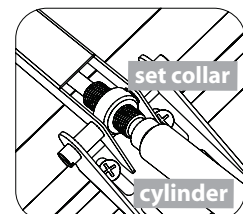
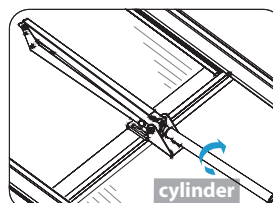

4 Install

b to RION greenhouses

NOTE: Follow steps one through three for assembly before installing.

From the inside of the greenhouse open arms of auto vent slightly. Place window bracket on arm B onto top edge of central mounting pad of window frame. Secure with two 3/8" self tapping screws (screw A). Make sure window bracket does not touch polycarbonate panels.

Insert gripping channel into groove in sill bar, pushing firmly into place. Slide along sill bar to position in line with central mounting pad on window frame.

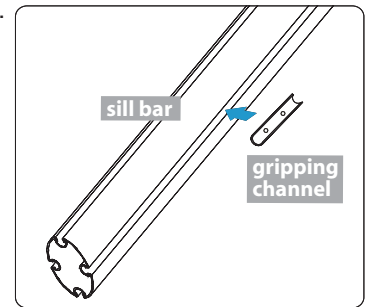
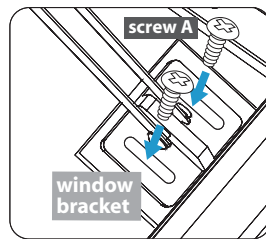
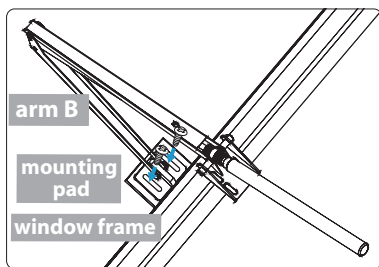

Place frame bracket on arm A onto sill bar just below frame bracket. Line up holes in gripping bar with holes in sill bracket and secure with two 1" self tapping screws (screw B). If necessary drill 3mm holes through sill bracket and holes in gripping channel.

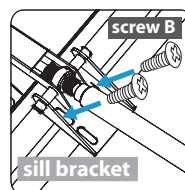
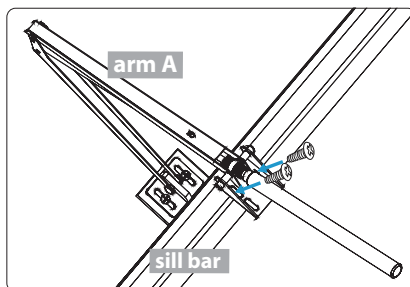

Carefully push upper handle B down until window closes completely. Turn cylinder clockwise until threaded area of cylinder is centered to set collar as shown.

IMPORTANT: Tighten the cylinder when you finish or the auto vent will not function.

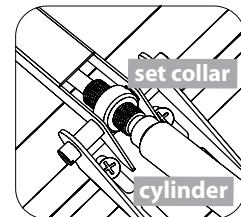
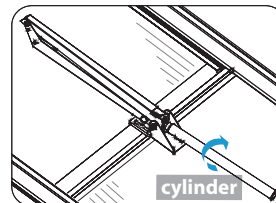

Note: In case there are any window handles and pivot pins installed, remove and store in a safe place.

Note: For installation with Easy-Grow greenhouses, see the Easy-Grow greenhouse manual for detailed instructions.

5 Adjust

The auto opener opens the greenhouse window when it reaches the set temperature. To set the temperature, hold the window slightly open and turn the cylinder until the auto opener begins to support the window without assistance. Turn the cylinder clockwise to raise the temperature and counterclockwise to lower the temperature.

Each complete turn adjusts the temperature approximately .5° to 1°. You can set the opening temperature range between 15° to 25° C (59° to 77°F).

Note: It is easier to set the temperature with the window slightly open, and partially supported with one hand until the auto opener supports the window completely.

Caution:

- Do not heat to more than 50°C (122°F).
- Do not apply excessive loads by locking or covering window.
- Do not attempt to dismantle cylinder.

Technical Information:

- Window will open a maximum of 45cm (18 in).
- Suitable for greenhouse weighing up to 7kg (15lb)
- Opening temperature range can be adjusted between 15° and 25° C (59° and 77°F).

Maintenance:

After installing, lubricate all moving parts with a light oil such as WD40. Do this each spring and autumn. Use grease or petroleum jelly for the piston rod.

After long periods of cold weather or at least once a year, support the window with one hand while rotating the cylinder slowly clockwise several turns and then rotate it slowly back to its original position.

Remove the vent opener (or at least the cylinder) when the temperature in the greenhouse exceeds 50°C/122°F or if you are not going to be using it for a long period of time. Store in a dry place. Before re-installing, lubricate the piston rod to ensure moves smoothly.

If you have any questions please contact our Customer Service department. Thank you for your business!



Systems Trading Corporation
450 7th Avenue Suite 2809, New York, NY 10123
Customer Service: (877) 407-9100 ext 1 Email: customerservice@stcaustin.com